





SKU: BV5089

-  VOLT ASA 150 Flanged Manual Ball Valve in Stainless Steel
-  VOLT ASA 150 Flansch Anleitung Kugelhahn in Edelstahl Steel
-  VOLT Válvula manual de bola con bridas ASA 150 en acero inoxidable
-  VOLT ASA 150 à brides vanne à boisseau sphérique manuel en acier inoxydable

Valves[™]
O N L I N E

- 1/2" - 4" Stainless steel ANSI 150 flanged ball valve
- 1/2" - 4" Edelstahl ANSI 150 Flansch Kugelhahn
- 1/2" - 4" ANSI 150 válvula de bola con bridas de acero inoxidable
- 1/2" - 4" Acier inoxydable ANSI 150 vanne à boisseau sphérique à bride

Flanged ANSI 150 Manual Ball Valve



- ASA Flanged
- Full Bore
- DIN 3202 F-4 face to face
- 180° C
- Stainless Steel
- PTFE Seats and Seals

DESCRIPTION

A good quality, cost effective general purpose flanged ball valve suitable for most Liquid and Gaseous duties. 2-Pce Full Bore flanged ASA150 ball valve. ASTM A351 CF8M 316 Stainless Steel construction, 316 Trim. PTFE Seats and Seals. Adjustable gland. Lever operated. The valve is suitable for manual on off operation and offers a non direct mount Fire-safe design (not certified). 1/2" - 2" PN40 pressure rated. 2 1/2" - 4" PN16 pressure rated. -20°C + 180° C Temperature rated. CE marked (sizes 1 1/4" upward) in accordance with the PED 97/23. ANSI B16.10 Face to Face dimension Test standard – API 598 Full material Test Certificates available. Available size range: 1/2" - 6"



Description

Volt 2 piece ASA150 flanged manual ball valve with full port in stainless steel. This valve offers economy with high performance. Size 1/2" to 4" supplied with Lever Handle Temperature Range -20° C to 180° C. CE marked (sizes 1 1/4" upward) in accordance with the PED 97/23.



Beschreibung

Volt 2 Stück ASA150 angeflanscht manuellen Kugelhahn mit vollem Durchgang aus Edelstahl. Dieses Ventil bietet Wirtschaft mit hoher Leistung. Größe 1/2" bis 4" geliefert mit Hebelgriff Temperaturbereich -20° C bis 180° C CE-Kennzeichnung (Größen 1 1/4" nach oben) in Übereinstimmung mit der PED 97/23.







Descripción

2 voltios pieza ASA150 bridas de válvula de bola manual con puerto completo en acero inoxidable. Esta válvula ofrece la economía con un alto rendimiento. Tamaño 1/2" a 4" suministrado con la manija de palanca Rango de temperatura de -20° C a 180° C. con marca CE (tamaños 1 1/4" hacia arriba), de conformidad con la PED 97/23.



Description

Volt 2 pièce ASA150 bridé vanne manuelle à bille avec passage intégral en acier inoxydable. Cette vanne offre l'économie avec la haute performance. Taille 1/2" à 4" fourni avec poignée à levier Plage de température -20° C à 180° C Marqués CE (tailles 1 1/4" vers le haut), conformément à la PED 97/23.

-  VOLT ASA 150 Flanged Manual Ball Valve in Stainless Steel
-  VOLT ASA 150 Flansch Anleitung Kugelhahn in Edelstahl Steel
-  VOLT Válvula manual de bola con bridas ASA 150 en acero inoxidable
-  VOLT ASA 150 à brides vanne à boisseau sphérique manuel en acier inoxydable

ANSI 150 St.St Lever Operated Ball Valve

- ASA 150 Flanged
- Full Bore
- Lockable Handle
- 180° C
- Stainless Steel

MATERIALS			
ITEM	DESCRIPTION	MATERIAL	NO.
1	BODY	CF8M	1
2	BALL SEAT	RPTFE	1
3	BALL	CF8M	1
4	BODY SEAT	PTFE	1
5	NUT	304	4 or 8
6	BOLT	304	4 or 8
7	CAP	CF8M	1
8	STEM SEAL	PTFE	1
9	STEM PACKING	PTFE	1
10	GLAND	CF8M	1
11	STOPPER	304	1
12	SNAP RING	304	2
13	STEM	304/316	1
14	BOLT	304	2
15	HANDLE	CF8	1

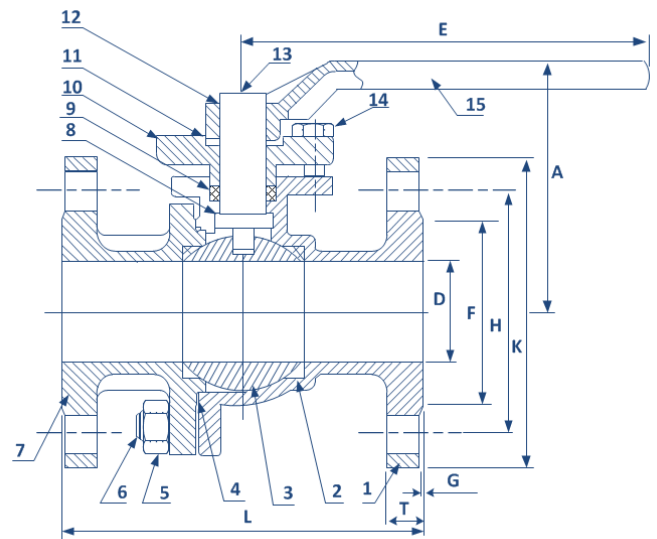

A good quality, cost effective general purpose flanged ball valve suitable for most Liquid and Gaseous duties. ANSI B16.10 Face to Face dimension. Full material Test Certificates available.

DIMENSIONS											
SIZE	A	B	C	D	E	F	H	K	T	G	L
1/2"	74.6	11	130	15	130	35	60.5	89	11	2	105
3/4"	79	11	130	20	130	43	70	98	11	2	117
1"	86	14	160	25	160	51	79	108	12	2	127
1 1/4"	91	14	160	32	160	64	89	117	13	2	140
1 1/2"	116	17	200	38	200	73	98.6	127	15	2	165
2"	127	17	200	50	200	92	120	152	16	2	178
2 1/2"	136	17	200	65	200	105	139	178	18	2	190
3"	164	22	325	80	325	127	152	190	19	2	203
4"	178	22	325	100	325	157	190	229	2	2	229