





SKU: KG5016

-  Cast Iron Knife Gate Valve - Unidirectional
-  Gusseisen -Plattenschieber - einfachgerichtet
-  Reparto de la válvula Puerta de Hierro Knife - unidireccional
-  Cast Iron Gate Valve couteau - unidirectionnelle

**Valves**<sup>™</sup>  
O N L I N E

- 2" - 16" Cast Iron Knife Gate Valve – EPDM Seat – 304 St St Gate
- 2" - 16" Cast Iron Knife Gate Valve – EPDM Seat – 304 St St Gate
- 2" - 16" Reparto de la válvula de puerta del cuchillo de hierro - EPDM Asiento - 304 St St Puerta
- 2" - 16" Fonte Vanne guillotine - EPDM Siège - 304 St St Porte



### Cast Iron Knife Gate Valve Lugged PN10



#### Description

VOLT Economy Unidirectional Knife gate valve, cast iron powder coated body, having a full circular bore which allows a high flow capacity with a very low pressure drop. EPDM seats with 304 stainless steel gate, rising stem Handwheel operated. Fits between PN10 Flanges.



#### Beschreibung

VOLT Economy gerichtet Keilschieberventil , Katze Eisenpulverbeschichtung, mit einer vollständigen kreisförmigen Bohrung , die eine hohe Durchflussleistung mit einem sehr niedrigen Druckabfall ermöglicht . EPDM Sitze mit 304 Edelstahl -Tor, steigende Spindel Handrad betrieben . Passend zwischen Flansche PN10 .



#### Descripción

Válvula de compuerta VOLT Economía unidireccional Cuchillo, polvo de hierro gato cuerpo recubiertas , que tiene un orificio circular completo que permite una capacidad de flujo alta con una caída de presión muy baja . Asientos de EPDM con 304 puerta de acero inoxidable , el aumento del volante madre operados . Se adapta entre PN10 Bidas .



#### Description

VOLT économie unidirectionnel Vanne à guillotine , de la poudre de fer de chat corps revêtu , ayant un trou circulaire complète qui permet un débit élevé avec une très faible perte de pression . Sièges EPDM avec 304 porte en acier inoxydable , tige montante Volant exploités . Convient entre PN10 Brides .

- Offers Excellent Economy
- 2"-16"
- EPDM Seal with Stainless Steel Gate

#### Description:

Volt economy cast iron, powder coated handwheel operated Uni-Directional Knife Gate Valve. Lugged and Tapped Pattern suitable to fit between PN10 flanges upto 10" and PN6 flanges 12"-16". EPDM seal and stainless steel 304 grade gate. This valve is ideally suited for general industrial service applications.

The design of the body and seat assures non clogging shut off on suspended solids in industries such as: Pulp and Paper /Power plants / Wastewater treatment plants / Chemical plants /Food, Biogas and Beverage / Bulk handling / Mining.





Temperature good for - 10°C to 120°C

**PN10 2" -10"**

**PN6 12"-16"**

**PN10 Rated**

**- 10°C to 120°C**

-  Cast Iron Knife Gate Valve - Unidirectional
-  Gusseisen -Plattenschieber - einfachgerichtet
-  Reparto de la válvula Puerta de Hierro Knife - unidireccional
-  Cast Iron Gate Valve couteau - unidirectionnelle

## Cast Iron Knife Gate Valve – PN10-PN6

- Offers Excellent Economy
- 2"-16"
- Handwheel Operated
- EPDM Seat and Stainless Gate

Pressure / Temperature Rating		
Pressure	2" - 10"	10 Bar
	12" - 16"	6 Bar
Temperature	EPDM Seats	120°C

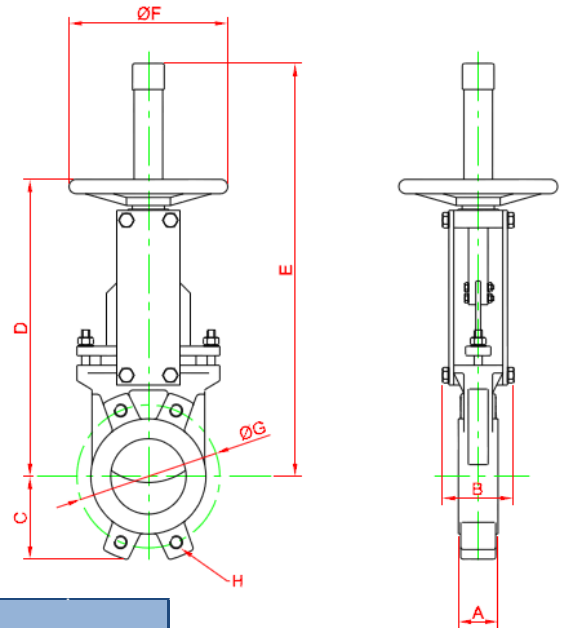

DIMENSIONS							
DN	INCHES	A	D	ØG	H		Kg
					No	PN10	
50	2"	48	165	125	4	M16	6.5
65	2 1/2"	48	185	145	4	M16	7
80	3"	51	200	160	8	M16	9
100	4"	51	220	180	8	M16	10.5
125	5"	57	250	210	8	M16	12.5
150	6"	57	285	240	8	M20	15
200	8"	60	340	295	8	M20	32.5
250	10"	70	395	350	12	M20	47
300	12"	76	445	400	12	M20	61
350	14"	76	505	460	16	M20	104
400	16"	89	565	515	16	M24	133

Material List		
Item	Part	Description
1	Body	GG25 Cast Iron
2	Gate	AISI 304
3	Seat	EPDM
4	Packing	NBR + PTFE
5	Stem	AISI 303
6	Stem Nut	Bronze
7	Yoke	Carbon Steel - Epoxy Coated
8	Support Plates	Carbon Steel
9	Handwheel	Cast Steel
10	Seat Retaining Ring	AISI 304
11	Thrust Washer	Bronze
12	Stem Protector	Carbon Steel Painted
13	Powder Coating	RAL - 5015 Blue

**Options**  
**Operators:**  
Handwheel, Lever, Pneumatic,  
Side Protection Plates